

# ANILLAS RINGS

## ANILLAS TIR TIR RINGS

### ANILLA ABATIBLE TIR FOLDAWAY TIR RING

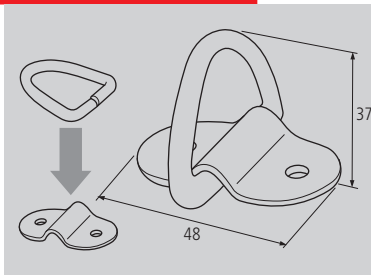

Material	Peso	Acabado	Extra	Ref.
Acero	0.036kg	Cincado		EAT
Nota				

## ANILLA-ASA TIRADOR DE TOLDO TARPULIN RING-HANDLE

### ANILLA-ASA INOXIDABLE PARA TIRADOR DE TOLDO RING-HANDLE FOR TAURPAULIN

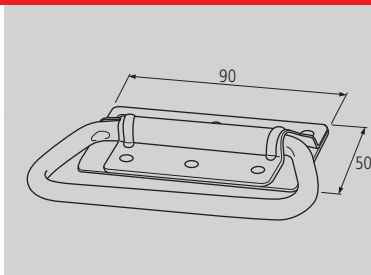

Material	Peso	Acabado	Extra	Ref.
Acero INOX	0.19kg			EAITT
Nota				

# CAJAS PRECINTO TIR TIR SEALING BOXES

## CAJAS PRECINTO TIR TIR SEALING BOXES

### CAJA PRECINTO TIR TIR SEALING BOX

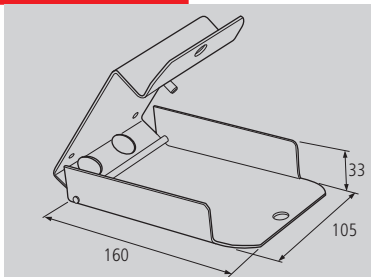

Material	Peso	Acabado	Extra	Ref.
Acero	0.70kg	Bicromatado		ECT
Nota				

### CAJA PRECINTO TIR (PLÁSTICO) TIR SEALING BOX (PLASTIC)

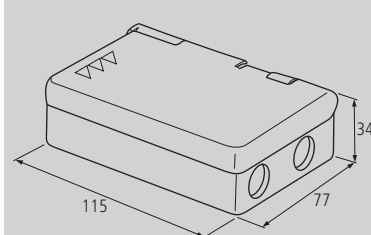

Material	Peso	Acabado	Extra	Ref.
Plástico	0.10kg			ECTP
Nota				

# CABLE PRECINTO TIR TIR SEALING CABLE

## CABLE PRECINTO TIR TIR SEALING CABLE

### CABLE PLASTIFICADO PRECINTO TIR 6mm. (LONGITUD 40M.) LAMINATED TIR SEALING CABLE 6mm. (40M. LENGHT)

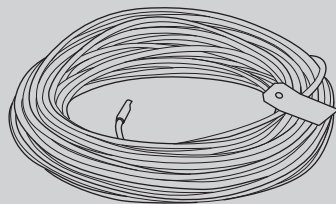

Material	Peso	Acabado	Extra	Ref.
Sirga acero	1.87kg			ECT40
Nota		Recubierta de plástico.		

#### COMPONENTES COMPONENTS

METROS CABLE (6mm.)

TERMINAL de CABLE (6mm.)

REMACHE LATÓN PULIDO para CABLE (6mm.)

CLAVO ALUMINIO para TERMINAL TIR

Material	Peso	Acabado	Extra	Ref.
Sirga acero				ECP
Acero				ETT
Latón				ERT
Aluminio				ECTA

## ENGANCHE CABLE PRECINTO TIR TIR SEALING CABLE HITCH

### ENGANCHE PLÁSTICO PARA ENROLLAR CABLE TIR EN FRONTAL PLASTIC HITCH TO COIL TIR CABLE ON FRONT

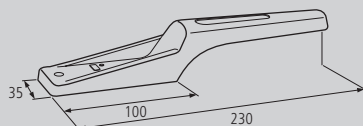

Material	Peso	Acabado	Extra	Ref.
Plástico	0.06kg			EEPCT
Nota				

# PIVOTES DE CUERDA ROPE PIVOTS

## PIVOTES DE CUERDA ROPE PIVOTS

### PIVOTE DE CUERDA FORJADO FORGED ROPE PIVOT



Material	Peso	Acabado	Extra	Ref.
Forja	0.032kg			EPCF
Nota				

### PIVOTE DE CUERDA TORNEADO TURNED ROPE PIVOT

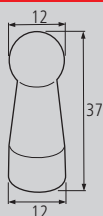

Material	Peso	Acabado	Extra	Ref.
Acero	0.020kg			EPC
Nota				