

## ANILLAS SUJECCIÓN DE CARGA LOAD FIXING RINGS

### ANILLA SUJECCIÓN DE CARGA LOAD FIXING RING

#### ANILLA SUJECCIÓN DE CARGA (PARA COLOCAR EN PILAR) LOAD FIXING RING (TO BE PLACED IN PILLAR)

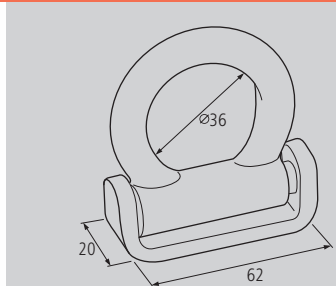

Material	Peso	Acabado	Extra	Ref.
Forja-acero	0.23kg			BACS
Nota				

### ANILLA SUJECCIÓN DE CARGA (EMPOTRADA) LOAD FIXING RING (EMBEDDED)

#### ANILLA EMPOTRADA EMBEDDED RING



\* Ref. BAC

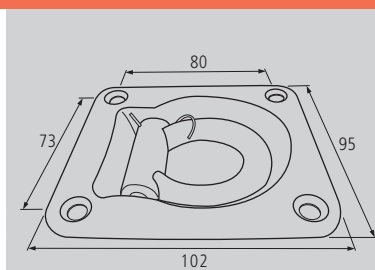

Material	Peso	Acabado	Extra	Ref.
Forja-acero	0.39kg			BAC *
Forja-acero INOX	0.18kg			BACI **
Nota				

#### ANILLA EMPOTRADA FORJADA EMBEDDED FORGED RING

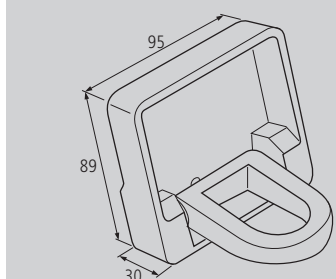

Material	Peso	Acabado	Extra	Ref.
Forja	0.94kg			BACF
Nota				

## ANILLA PARA AMARRE FASTENING RING

### ANILLA FORJADA ESTIBA CON SOPORTE DE CHAPA FORGED STOWING RING WITH PLATE BRACKET

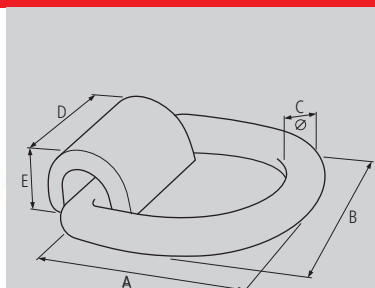

Material	Peso	Acabado	Tamaño estiba	A	B	C	D	E	Ref.
Forja-acero	1.15kg	Bicromatada	Pequeña	115	115	19	63	37	BACE
Forja-acero	2.12kg		Grande	155	130	26	65	44	BACEG
Nota									